

Damper actuator for adjusting air control dampers in ventilation and air-conditioning systems for building services installations

- Torque 4Nm
- Nominal voltage AC/DC 24V
- Control: Open-close (not made for 3-point applications)
- Running time 2.5s



Technical data

Electrical data	Nominal voltage	AC 24V, 50/60Hz / DC 24V
	Nominal voltage range	AC 19.2...28.8V / DC 21.6...28.8V
	Power consumption	In operation 13W @ nominal torque At rest 2W For wire sizing 23VA (I max. 20A @ 5ms)
	Connection	Cable 1m, 3 x 0.75mm ²
Functional data	Torque (nominal torque)	Min. 4Nm @ nominal voltage
	Direction of rotation	Reversible with switch 0 ↻ resp. 1 ↻
	Manual override	Gearing latch disengaged with pushbutton, can be locked
	Angle of rotation	Max. 95°↔, can be limited at both ends with adjustable mechanical end stops
	Angle of rotation limiting	min. 30°↔
	Running time	2.5s / 90°↔
	Automatic adjustment of operating range to match the mechanical angle of rotation	Manual triggering of the adaption by pressing the «Adaption» button
	Sound power level	52dB(A)
	Position indication	Mechanical, pluggable
	Negative torque	⚠ ≤50% from nominal torque (with restrictions)*
Safety	Protection class	III Safety extra-low voltage UL Class 2 Supply
	Degree of protection	IP54 in any mounting position NEMA 2, UL Enclosure Type 2
	EMC	CE according to 2004/108/EC
	Certification	Certified to IEC/EN 60730-1 and IEC/EN 60730-2-14 cULus according to UL 60730-1A and UL 60730-2-14 and CAN/CSA E60730-1:02
	Mode of operation	Type 1
	Rated impulse voltage	0.8kV
	Control pollution degree	3
	Ambient temperature	−30...+40°C (no restrictions) ⚠ +40...+50°C (with restrictions)*
	Non-operating temperature	−40...+80°C
	Ambient humidity	95% r.H., non-condensating
Maintenance	Maintenance-free	
Dimensions / Weight	Dimensions	See «Dimensions»
	Weight	Approx. 0.97kg

* Under these operating conditions, the lift cycle of actuator will be reduced. Please contact your Belimo representative for details

Dimensions [mm]

Dimensional drawings

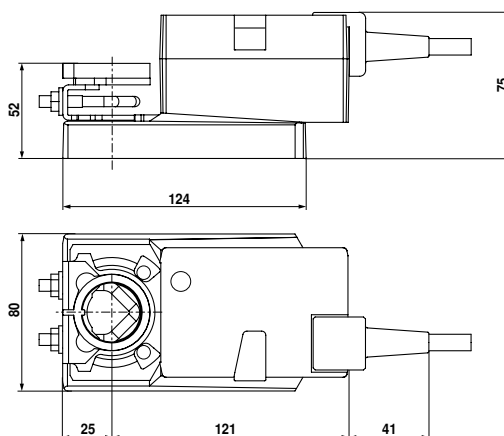

Damper spindle	Length	⊙	⊠	◇
	≥40	8...26.7	≥8	≤26.7
	≥20	8...20	≥8	≤20

* Option (accessory K-NA)
When using an auxiliary switch or feedback potentiometer.

UL marked actuators is optional, please contact your local Sales Representative for details.

Modulating damper actuator for adjusting air control dampers in ventilation and air-conditioning systems for building services installations

- Torque 4Nm
- Nominal voltage AC/DC 24V
- Control: modulating DC (0)2...10V
- Position feedback DC 2...10V
- Running time 2.5s

Technical data

Electrical data	Nominal voltage	AC 24V, 50/60Hz / DC 24V	
	Nominal voltage range	AC 19.2...28.8V / DC 21.6...28.8V	
	Power consumption	In operation	13W @ nominal torque
		At rest	2W
	For wire sizing	23VA (I max. 20 A @ 5 ms)	
	Connection	Cable 1m, 4 x 0.75mm ²	
Functional data	Torque (nominal torque)	Min. 4Nm @ nominal voltage	
	Control	Control signal Y	DC (0)2...10V, input impedance 100kΩ
		Operating range	DC 2...10V
	Position feedback (Measuring voltage)	DC 2...10V, max. 0.5mA	
	Position accuracy	±5%	
	Direction of rotation	Reversible with switch 0 / 1	
	Direction of motion at Y = 0 V	At switch position 0 ↺ resp. 1 ↻	
	Manual override	Gearing latch disengaged with pushbutton, can be locked	
	Angle of rotation	Max. 95°↔, can be limited at both ends with adjustable mechanical end stops	
	Angle of rotation limiting	min. 30°↔	
	Running time	2.5s / 90°↔	
	Automatic adjustment of operating range and measuring signal U to match the mechanical angle of rotation	Manual triggering of the adaption by pressing the «Adaption» button	
	Sound power level	52dB(A)	
	Position indication	Mechanical, pluggable	
	Negative torque	≤50% from nominal torque (with restrictions)*	
Safety	Protection class	III Safety extra-low voltage, UL Class 2 Supply	
	Degree of protection	IP54 in any mounting position NEMA 2, UL Enclosure Type 2	
	EMC	CE according to 2004/108/EC	
	Certification	Certified to IEC/EN 60730-1 and IEC/EN 60730-2-14 cULus according to UL 60730-1A and UL 60730-2-14 and CAN/CSA E60730-1:02	
	Mode of operation	Type 1	
	Rated impulse voltage	0.8kV	
	Control pollution degree	3	
	Ambient temperature		-30...+40°C (no restrictions)
			+50°C (with restrictions)*
	Non-operating temperature	-40...+80°C	
Ambient humidity	95% r.H., non-condensating		
Maintenance	Maintenance-free		
Dimensions / Weight	Dimensions	See «Dimensions»	
	Weight	Approx. 0.98kg	

* Under these operating conditions, the lift cycle of actuator will be reduced. Please contact your Belimo representative for details

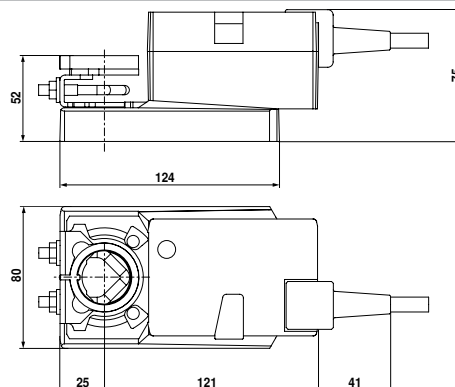
Dimensions [mm]
Dimensional drawings

Damper spindle	Length			
	≥40	8...26.7	≥8	≤26.7
	≥20	8...20	≥8	≤20

* Option (accessory K-NA)
When using an auxiliary switch or feedback potentiometer.

UL marked actuators is optional, please contact your local Sales Representative for details.

Wiring diagrams: Open/Close actuators – parallel connection possible, please note the performance data

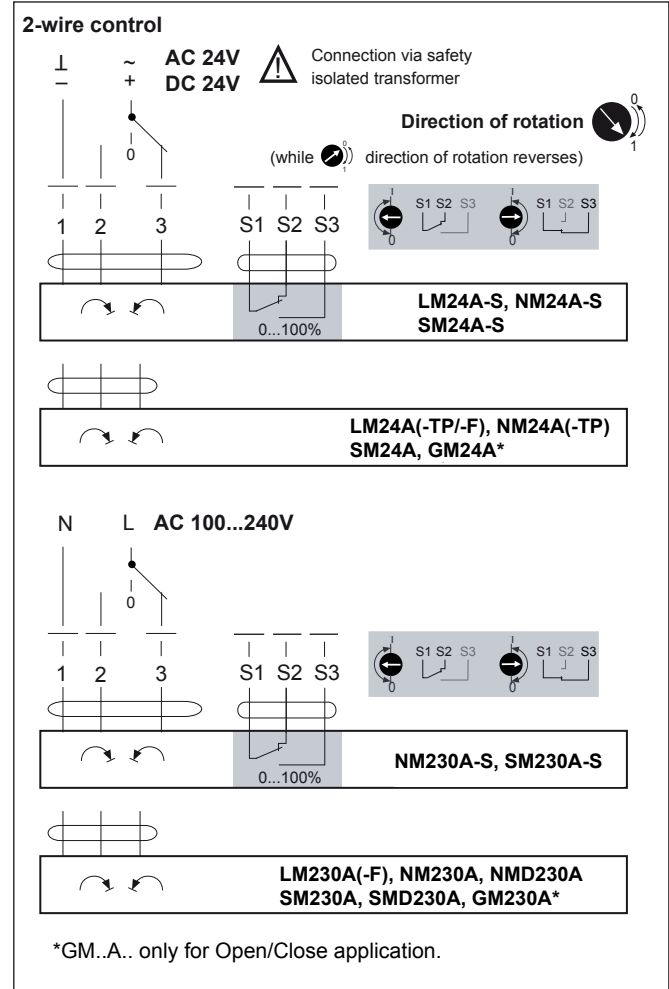
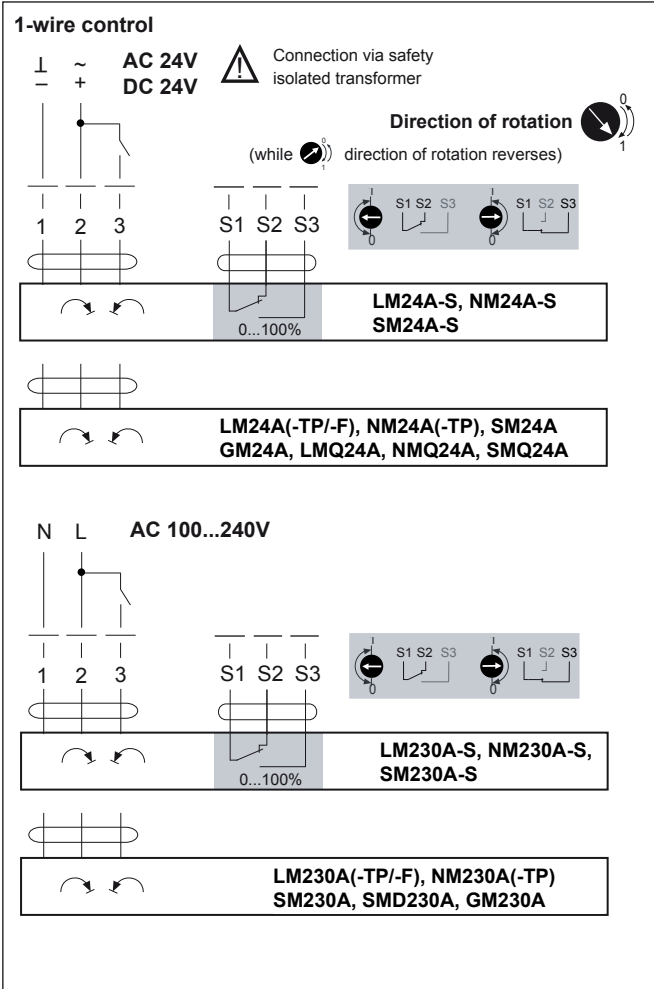

Wiring diagrams: Modulating actuators – parallel connection possible, please note the performance data

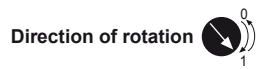
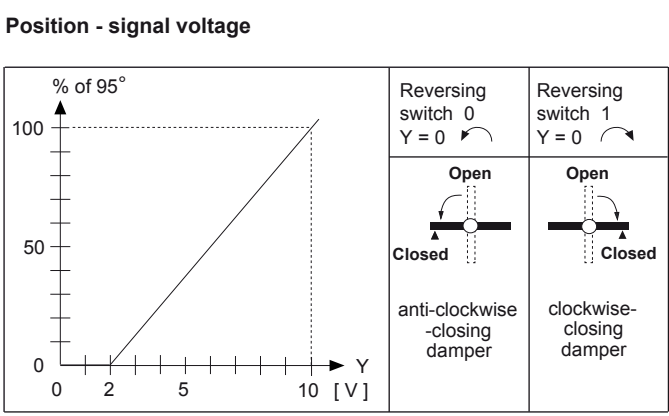
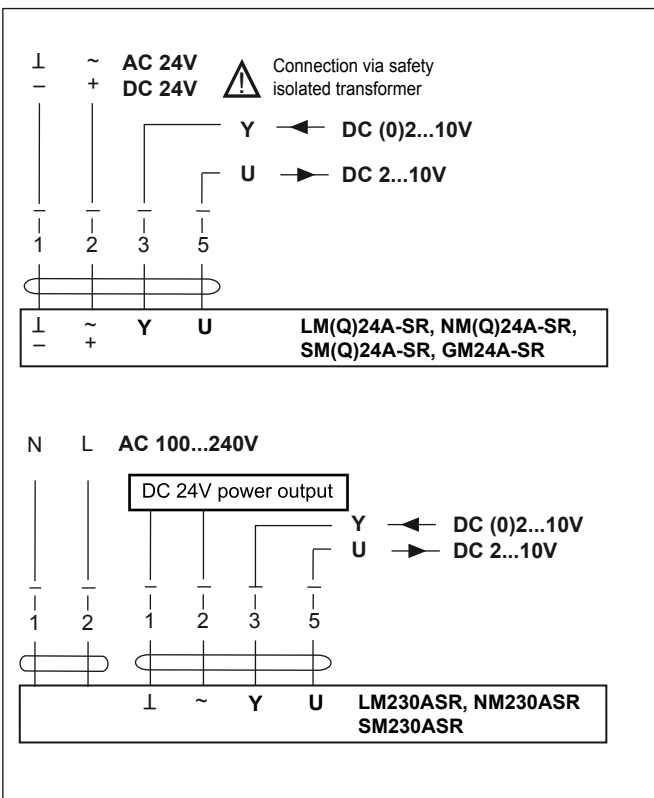

V6.2.03.2015•Subject to modification